

# FRUITION®

## Garden Fruit Fly Trap

### Instructions for Trap Assembly and Use

Fruition® Garden Fruit Fly Traps are specifically designed to attract and trap pest fruit flies in the home garden using a unique combination of trap shape and colour, and attractant lures.

One part of the lure system is designed to attract egg laying female fruit flies to the trap. This is a unique lure designed and developed by the International Centre for Management of Pest Fruit Flies at Griffith University in Brisbane. The second lure is a protein bait which attracts immature male and female fruit flies to the trap, removing them from the garden before they have the opportunity to mate and lay eggs.

The design of the Fruition Garden Fruit Fly Trap is based on the Fruition® Nova® Trap which is widely used in commercial

fruit and vegetable crops to manage fruit fly populations and reduce crop damage.

Fruition Garden Fruit Fly Lures use naturally-occurring ingredients. The Fruition Garden Fruit Fly cages are made from recycled plastic and are recyclable. Fruition Garden Fruit Fly Traps are non-toxic and pesticide-free.

Fruition Garden Fruit Fly Traps attract and trap all of the main pest species of fruit fly, including Queensland fruit fly (*Bactrocera tryoni*), lesser Queensland fruit fly (*Bactrocera neohumeralis*), Jarvis' fruit fly (*Bactrocera jarvisi*), cucumber fruit fly (*Bactrocera cucumis*), and Mediterranean fruit fly (*Ceratitis capitata*).

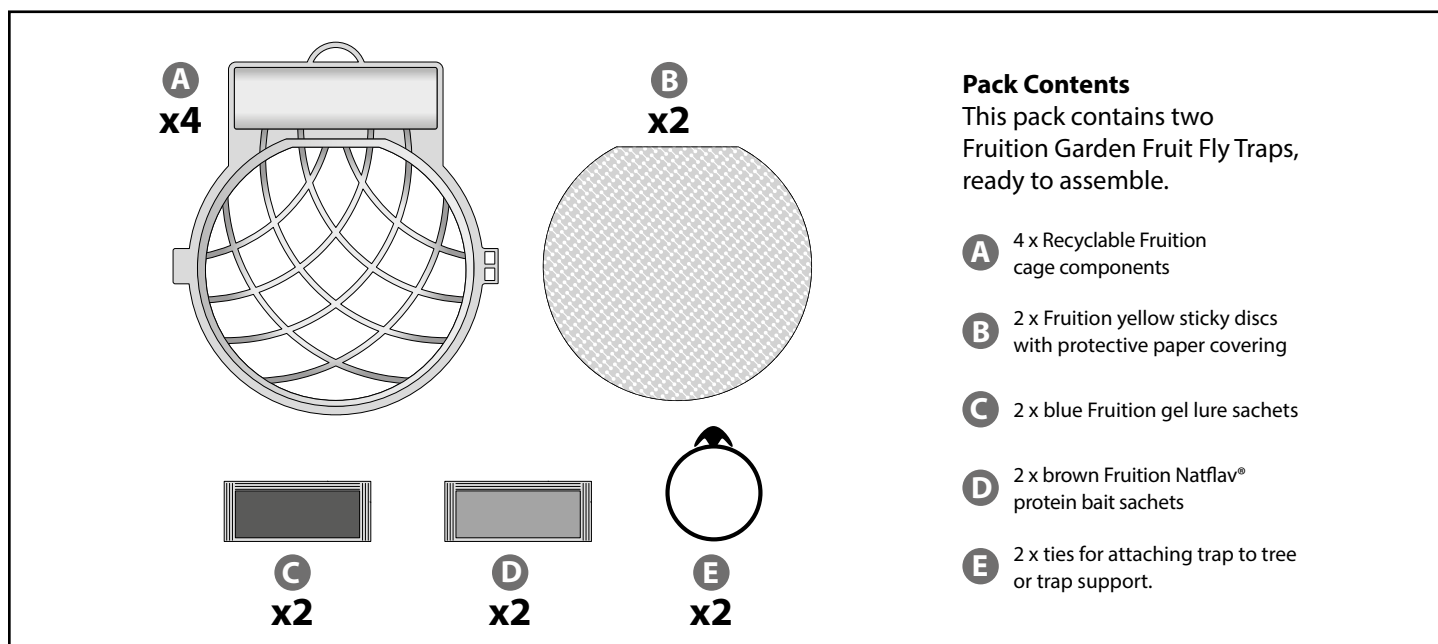

### Use Recommendations:

1. Fruition Garden Fruit Fly Traps are effective for up to 12 weeks.
2. Fruition Garden Fruit Fly Traps should be deployed before fruit becomes attractive to fruit flies, generally when fruit is hard and green, before it begins to ripen.
3. Use one trap per tree for trees up to 3 m in height and two traps per tree for larger trees.
4. In fruit trees, hang traps at a height of 1.5-2 m above ground. For trees up to 3 m in height, hang the trap on the northern side of the tree in the outer part of the canopy where the trap is visible but not exposed to constant sunlight. In addition, for trees greater than 3 m in height, hang a second trap on the southern side of the tree.
5. In vegetable crops, secure the trap to a tomato stake or similar rigid support at a height just above the canopy of the crop. Use one trap per 10 m x 10 m area.
6. Replace the trap if the disc becomes densely covered in fruit flies or the lure sachets have been opened for more than 12 weeks.
7. Avoid contact with the adhesive surface of the trap. The adhesive is non-toxic and can be removed from skin using vegetable oil.
8. Disassemble used traps at the end of the season and dispose of the components through normal domestic waste and recycling collections.

# FRUITION®

## Garden Fruit Fly Trap

### Trap Assembly Instructions

**1** Lay out the components for assembling one trap on a stable flat surface

- A** 2 x Recyclable Fruition cage components
- B** 1 x Fruition yellow sticky disc with protective paper covering
- C** 1 x blue Fruition gel lure sachet
- D** 1 x brown Fruition Natflav® protein bait sachet
- E** 1 x tie for attaching trap to tree or trap support.

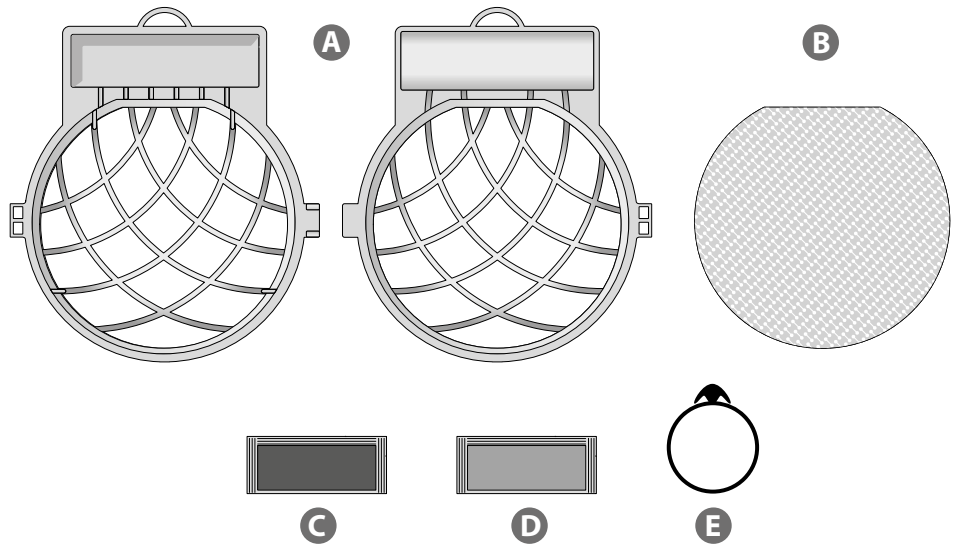

**2**

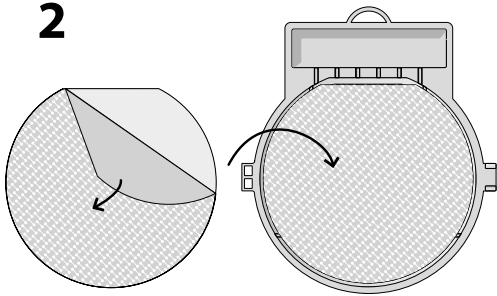

Peel the protective paper layer off one side of the disc then place the disc, **sticky side down**, into one half of the trap cage applying gentle pressure to ensure that the disc is resting on the supporting lugs on the sides of the trap cage (gloves can be useful to avoid getting adhesive on fingers).

**3**

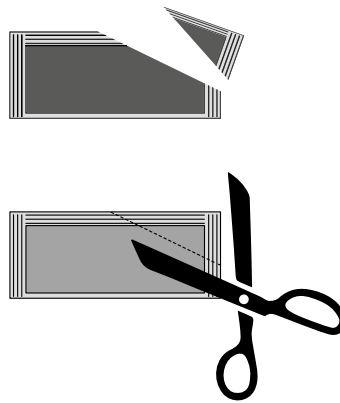

Use a pair of scissors to cut the corner of the sachets containing the Fruition gel lure and the Fruition Natflav protein bait.

**4**

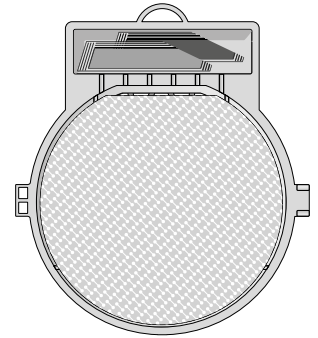

Place the sachets with the cut corner **upwards** in the chamber at the top of the trap.

**5**

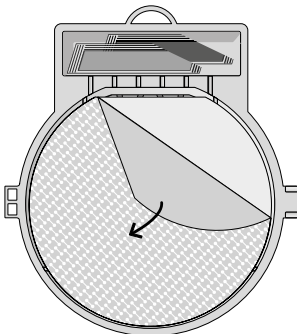

Peel the protective paper off the other side of the yellow disc.

Avoid contact with the adhesive surface of the trap.

The adhesive on the traps is non-toxic.

Application of vegetable oil to any surface which has picked up any adhesive (eg, gloves, scissors, etc) will remove the sticky deposit.

**6**

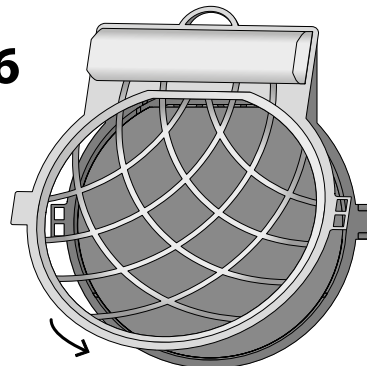

Place one half of the trap over the other half and push down to snap shut.

**7**

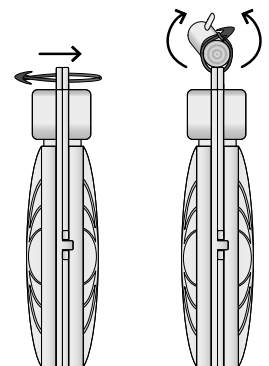

Use the tie provided to attach the trap securely to a branch in the tree to be protected, or to a firm support in the vegetable patch to be protected.